

LS-10

Multistage Centrifugal Turbo Blower



MODEL LS-10

Standard Specifications

| | |
|----------------------------|--|
| Gas | Air, CO ₂ , Biogas, Steam, H ₂ S, Fuel Gas, N ₂ , LNG, Custom |
| Flow Range | 100% to 45% of Rated Flow* |
| Pressure Range | 20 PSIG / 1379 mbar Delta |
| Maximum Case Pressure | 45 PSIG / 3.1 bar |
| Stages | 1 to 9 (10 at 50Hz) |
| Drive Type | Direct Coupled, Belt Drive |
| Power Driver Options | Electric 2-Pole Motor, Steam Turbine, Combustion Engine |
| Cooling | Self Cooled Air, Optional Integral Fan |
| Lubrication Options | Splash Lubricated Oil, or Mist Connections |
| Bearings | Anti-friction type AFBMA L10 up to 300,000 hrs |
| Enclosure | Optional |
| Sound Level | < 85 dba* |
| Sound Level with Enclosure | Job Specific |
| Filtration Rating (std) | 98% at 10 micron, or as required |
| Seals Air | Labyrinth Type |
| Seals Gas | Carbon Ring with Purge, Custom Available |
| Shaft End Dimension | 2.874 in (73mm) diameter at coupling |
| Inlet / Outlet Flange Size | 10" / 8" ASA 125# / ANSI 150# Drilling, Optional DIN 250/200 Adapter Flange |

Control Options

| | |
|--------------------|--|
| Control Methods | Variable inlet valve, speed control, blow off, or combination |
| Local Controller | sLOC™ Standard - Custom for Allen Bradley, Modicon, Siemens or Other |
| HMI | sLOC™ Standard or Custom HMI |
| Remote Monitoring | sLINK™ or Custom |
| Control Set Points | Pressure, Flow, Power, Custom Input |

Standard Materials of Construction

| | |
|--------------------------|--|
| Casing, Volute | ASTM A48 Class 25/30 Cast Iron, Ductile |
| Bearing Housings | ASTM A48 Class 25/30 Cast Iron, Ductile |
| Impeller | ASTM A365 T6 Cast Aluminum, ASTM AA-6061 Fabricated, Stainless |
| Shaft | ASTM A109 1045~, Stainless Steel |
| Seals Air | ASTM B86 Z25631 Zinc Alloy, Aluminum |
| Seals Gas | ASTM C695 Molded Graphite |
| Joint Sealing of Casings | RTV Silicon or O-Ring |
| Blower Base Skid | ASTM A36 Structural Steel |
| Isolation Pads | Neoprene Rubber |
| Finish | 2 Part Epoxy Lone Star Blue RAL5005 |

Optional Testing & Certifications

| | |
|----------------------|---|
| API | API 617, API 672 Features |
| Electrical | UL 508A, CE, CSA, Other |
| Hazardous Location | ATEX, Class1 - Division 1- Division 2, Zone 0-2 |
| Balancing | ISO 1940, G2.5 grade |
| Noise Level | OSHA 1910.95, ISO 2151:2004 |
| Performance | ASME PTC-10, PTC-13, ISO 5389 |
| Hydro Testing | 1.5 Time MAWP |
| Overspeed Testing | Optional |
| Positive Material ID | XRF, OES, Material Certification |
| NACE Compliance | Optional |
| Special Coatings | Optional |

Service

Air, Gas, Pressure, Vacuum

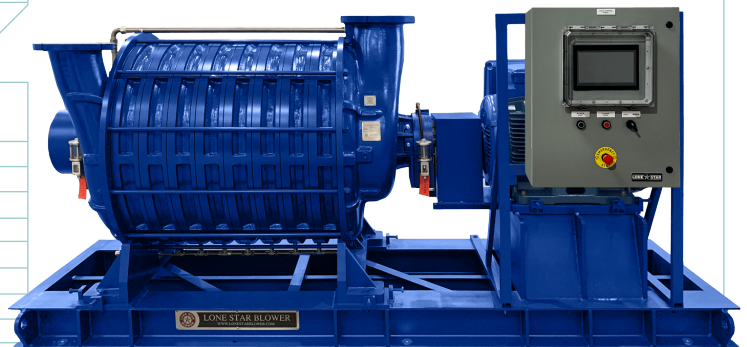
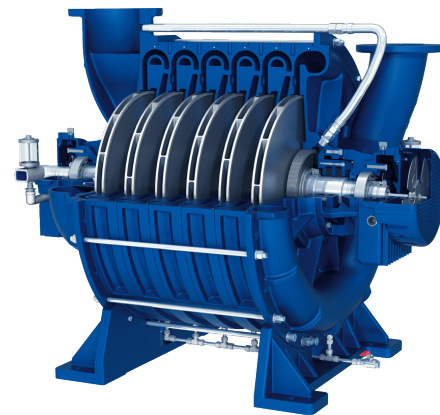
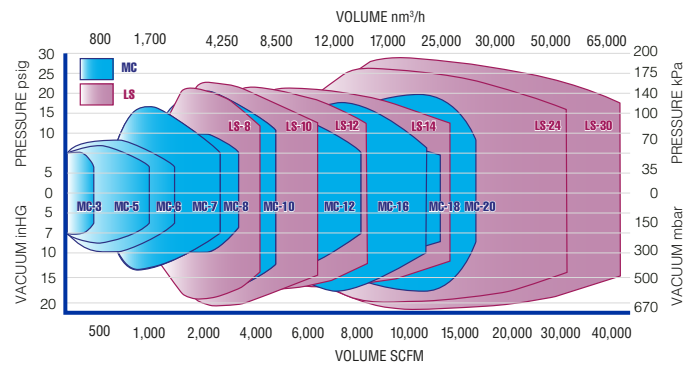
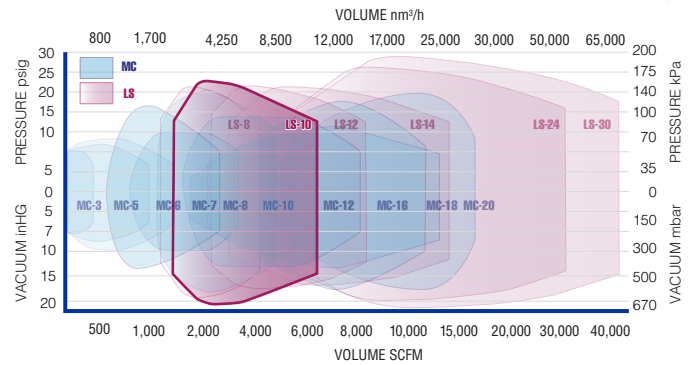

* Information is approximate and can change without notice
* Air Performance Based on 1 Atm, 68F/20C, 36% RH and 3550 rpm

| PACKAGED DIMENSIONS | | | |
|---------------------|--------------|--------------|------------|
| MODEL | A* | B* | L† |
| LS10-2 | 14.36 (365) | 20.81 (529) | 110 (2794) |
| LS10-3 | 19.48 (495) | 25.93 (659) | 120 (3048) |
| LS10-4 | 24.60 (625) | 31.05 (789) | 120 (3048) |
| LS10-5 | 29.72 (755) | 36.17 (919) | 130 (3302) |
| LS10-6 | 34.84 (885) | 41.29 (1049) | 140 (3556) |
| LS10-7 | 39.96 (1015) | 46.41 (1179) | 140 (3556) |
| LS10-8 | 45.08 (1145) | 51.53 (1309) | 150 (3810) |
| LS10-9 | 50.20 (1275) | 56.65 (1439) | 150 (3810) |

*DIMENSIONS ARE SHOWN IN INCHES (AND MILLIMETERS) ARE APPROXIMATE. DO NOT USE FOR CONSTRUCTION PURPOSES.

†DIMENSIONS VARY DEPENDING ON COUPLING & MOTOR FRAME SIZE.

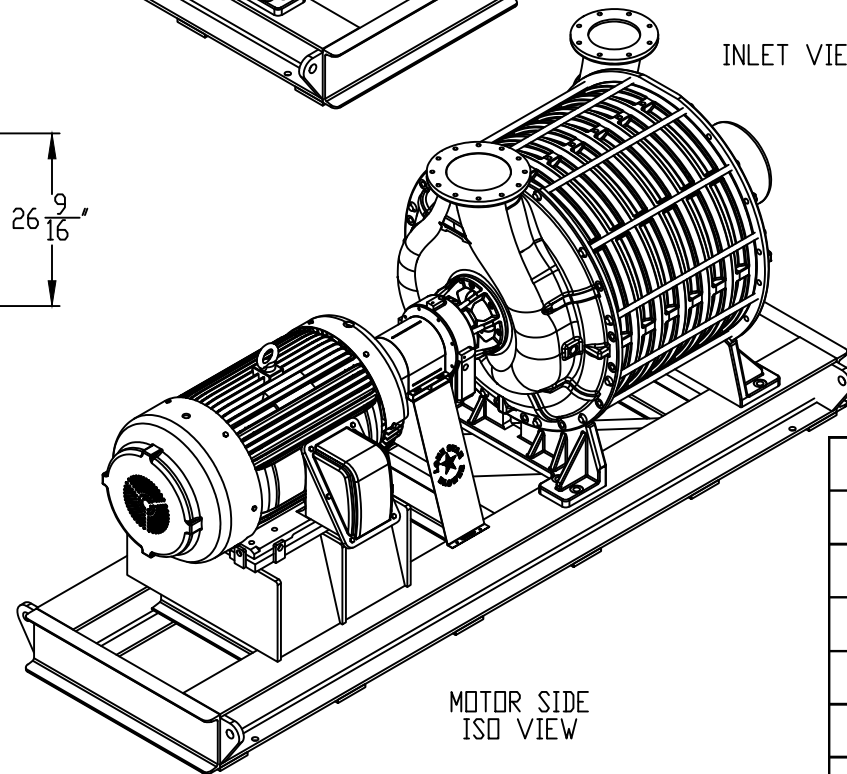
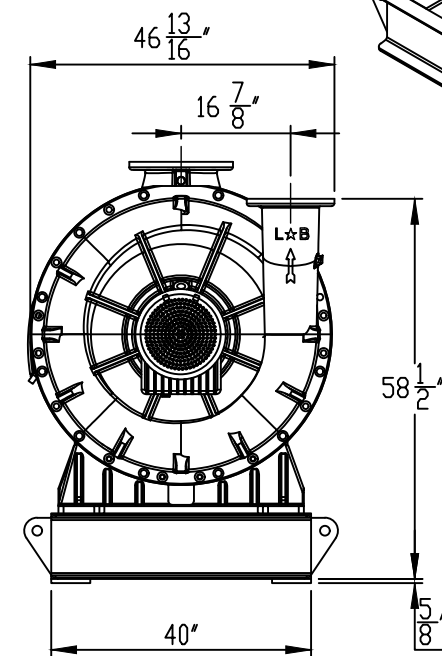
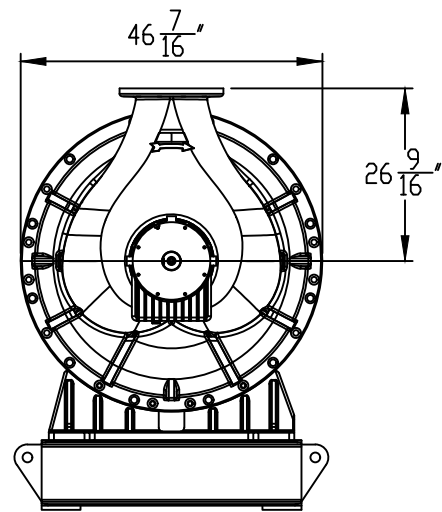
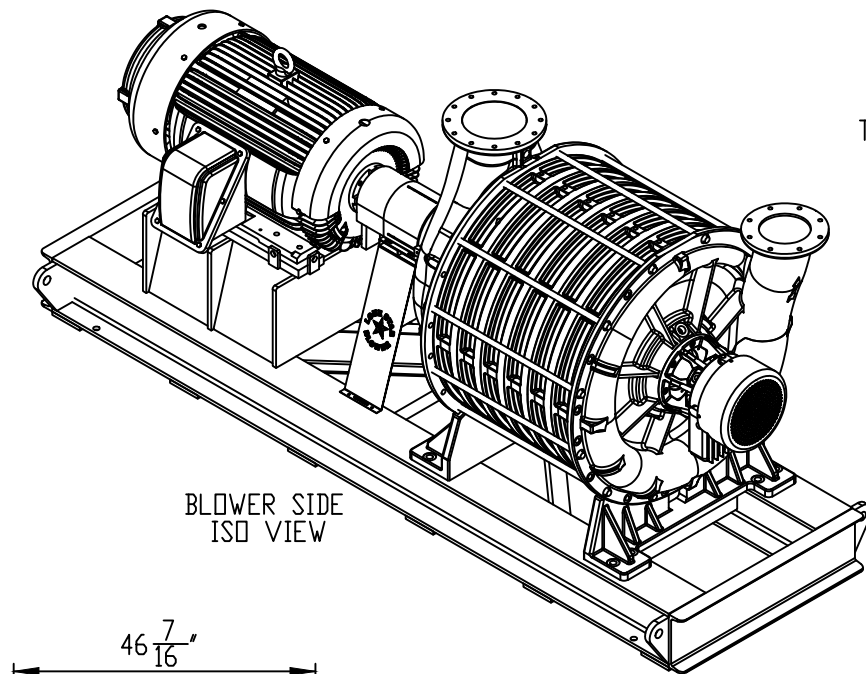
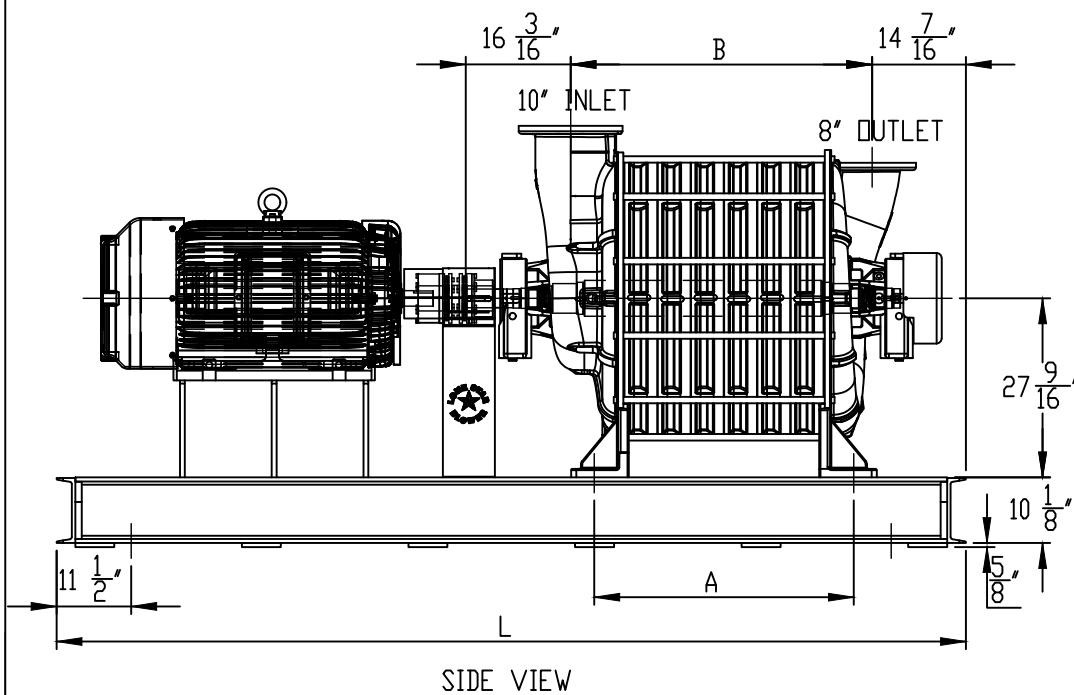
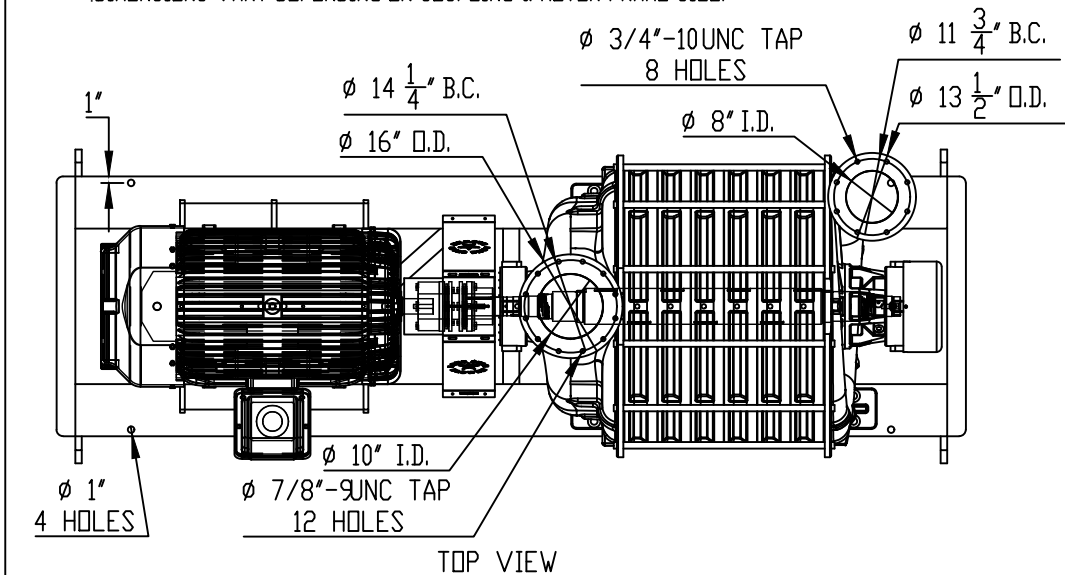

INLET & OUTLET ORIENTATION OPTIONS
THE ORIENTATION OF THE INLET AND OUTLET IS SELECTABLE FROM ANY OF THE THREE DIFFERENT POSITIONS, AS VIEWED WHEN FACING THE EXTERIOR OF THE PARTS.

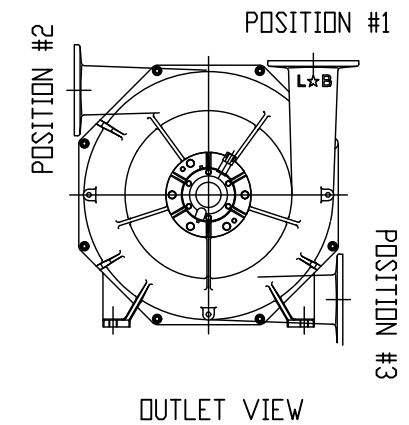
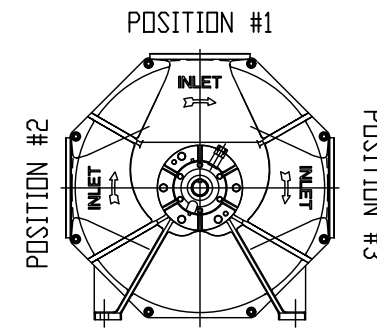

INERTIA BASED ON CAST IMPELLERS.
APPROXIMATE WEIGHT FOR BLOWER AND SKID MINUS MOTOR.

| MODEL | WEIGHT | | Wk ² | |
|--------|--------|------|--------------------|-------------------|
| | LB | Kg | LB-ft ² | Kg-m ² |
| LS10-2 | 4124 | 1871 | 23 | 0.96 |
| LS10-3 | 4857 | 2203 | 34 | 1.44 |
| LS10-4 | 5508 | 2498 | 45 | 1.92 |
| LS10-5 | 6241 | 2831 | 57 | 2.40 |
| LS10-6 | 6976 | 3164 | 68 | 2.88 |
| LS10-7 | 7626 | 3459 | 79 | 3.36 |
| LS10-8 | 8361 | 3792 | 91 | 3.84 |
| LS10-9 | 9012 | 4088 | 102 | 4.32 |

INTERPET ALL GEOMETRIC DIMENSIONING AND TOLERANCING TO ASME Y14.5

DRAWING IS FOR REFERENCE ONLY UNLESS SPECIFIED AS APPROVED

ALL DIMENSIONS ARE IN INCHES UNLESS OTHERWISE SPECIFIED

THE INFORMATION CONTAINED IN THIS DRAWING IS THE SOLE PROPERTY OF LONE STAR BLOWER. ANY REPRODUCTION IN PART OR AS A WHOLE WITHOUT THE WRITTEN PERMISSION OF LONE STAR BLOWER IS PROHIBITED.

STANDARD TOLERANCES

| | |
|--------|-------|
| .X | ±.015 |
| .XX | ±.010 |
| .XXX | ±.005 |
| X/X | ±1/16 |
| ANGLES | ± 1° |

DRAWN BY: DATE

CHECKED BY: DATE

APPROVED BY: DATE

REMOVE BURRS AND BREAK ALL SHARP EDGES MACHINED SURFACES

THIRD ANGLE PROJECTION

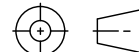

LS 10
MULTISTAGE TURBO

| | | |
|-------------|-----------------------|--------------|
| SIZE B | DWG. NO. MARKETING | REV 0 |
| SCALE: 1:50 | DO NOT SCALE | SHEET 1 OF 1 |